

**Buonato Granite & Marble**  
Stoughton, Massachusetts

**Site Development, Permitting & Construction Related Services**

**Project Description**

Coneco provided Engineering, Permitting and Surveying related services as part of this site development for a 14,000 s.f. multi tenant building. Site engineering included associated roadway/parking design with site distance issues, loading and secure storage areas, grading including retaining wall design, site utility design and coordination including sanitary sewer connections and permitting, stormwater management facilities in accordance with the Massachusetts DEP Stormwater Regulations including a substantial underground detention facility, lighting and landscaping design. Coneco provided on site construction services including shop drawing review, contractor requisitions and value engineering.

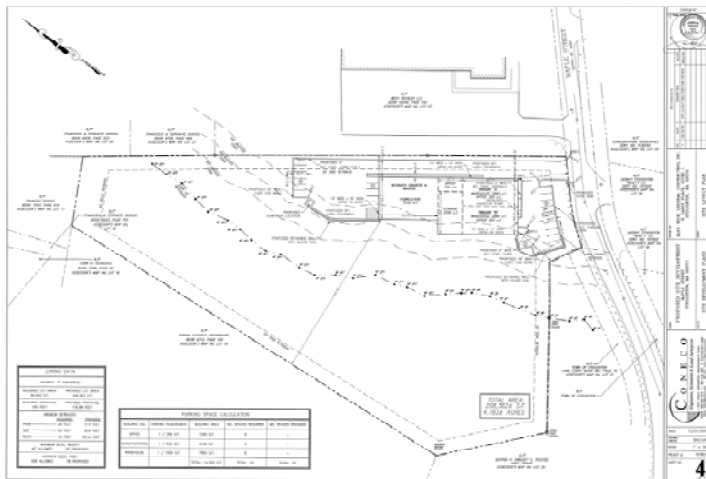

The new facility, which currently houses Buonato Granite & Marble and Autoparts International has been open since 2005 and has been a welcome addition to the Maple Street Industrial complex.

**Contact: Shane M. Oates, Senior Project Manager**  
(508) 245-2608 (cell) soates@coneco.com